

Both hulls contain guest cabins, which are equipped in the same manner. Since the hulls are "V-formed," the floors levels are relatively small, but become roomier at the upper portion. All cabins are accessible from above, but are also accessible to one another via doors. The standing room in the cabins are 187 cm.

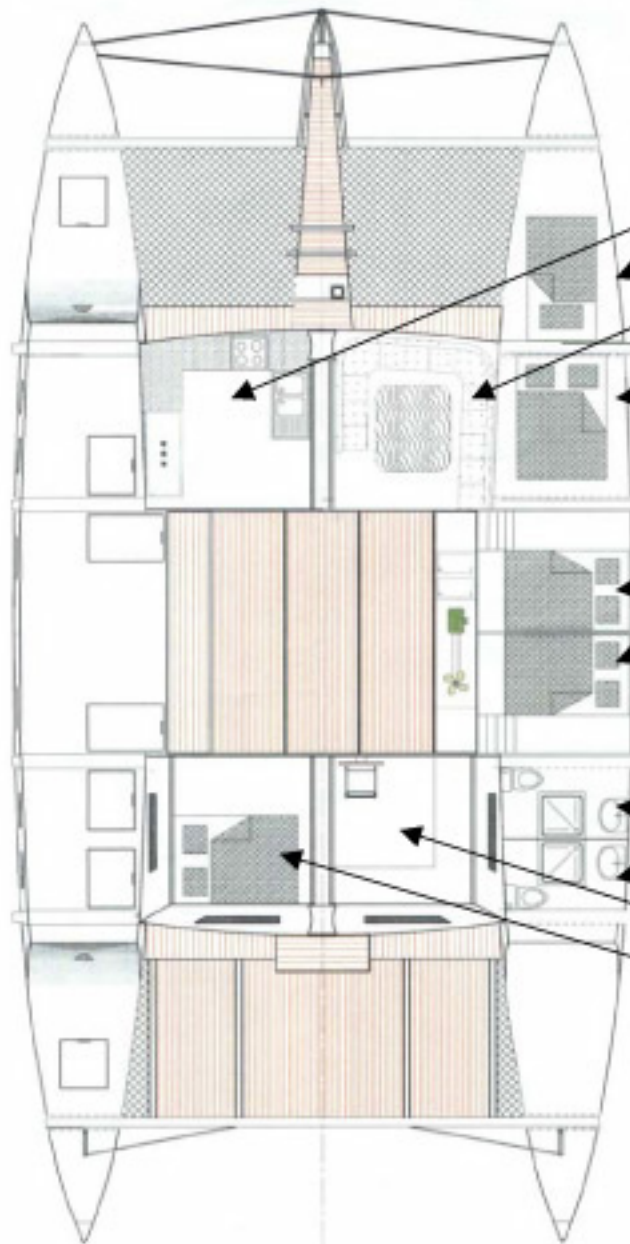

Galley with 400 liter refrigerator and freezer, stove, oven, sink and workspace

Crew Cabin

Main Cabin, seats 8-10 people. Floorspace Including seating: 272 x 235. Surface at widest point: 284 x 297 cm. Standing room by opened roof: 195 cm.

Double Cabin: Sleeping space: 128 x 200 cm. With little work, this cabin can be transformed into a workspace or storage space. Entrance is via a steep ladder. Floor space: 82 x 230 cm. Surface at widest point: 195 x 230 cm.

Two Double Cabins:

Either of these sleeping spaces can encompass one doublebed (140 x 200 cm) or two single bunkbeds (70 x 200 and 70 x 190 cm).

Comfortable, shallow gangway.

Floorspace: 85 x 192 cm, surface at the widest point: 230 x 190 cm.

The separating wall between these cabins can be removed, creating a larger space with the length of 385 cm and width of 230 cm.

Two separate bathrooms, each including shower, sink, mirrored cabinet and WC. Floorspace: 115 x 80. Surface at widest point: 115 x 195 cm.

Navigation and steering room

Skipper's Quarters